

GPS

Marine and Land Based GPS Antenna

GPS is a marine and land based antenna for the frequency 1575.42 MHz band. The GPS antenna can be installed directly on the deck, it withstands walking pressure, or on a rail mount or any of the 1"-14 thread standard mounts with adaptor N225F. The GPS is manufactured in premium quality materials in order to prevent galvanic corrosion.

GPS has been sold worldwide for more than four decades. The antenna is subject for improvement at all times. The antenna has the same rugged design as all other AC Antennas products thus it withstands harsh environmental conditions, both on sea and land.

Electrical specifications

Frequency range (MHz)	1575.42	
Nominal impedance (ohm)	50	
Gain (dB)	26	
Supply voltage (VDC)	3.0-5.5	
Noise figure (dB)	Typ. 1.35	
Antenna gain excl. LNA (dBic)	> 4.4	
VSWR	< 2:1	
Connector	FME(male)	
DC-shortcd	No	

Mechanical specifications

Length (mm)	Ø48 x 53 (16 above deck)
Weight (kg/lbs)	0.06/0.16
Wind rating (m/s / mph)	45/101
Material	ABS, Brass, Stainless steel
Colour	White
Temperature range (°C/°F)	-40 to +60 / -40 to +140
Ingress Protection	IP66

Mounting

No mount included.

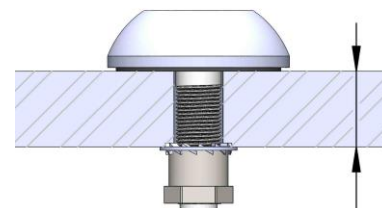

Max 20mm deck
(recommended)