

**Prevents** dead batteries from add-on equipment, maximizing operational readiness and saving maintenance costs.

**Delivers** power to equipment after engine off or at end of shift (video downloads), automatically timing off and optionally if battery voltage is low.

**Protects** sensitive on-board electronics via under-voltage and over-voltage shutdown.

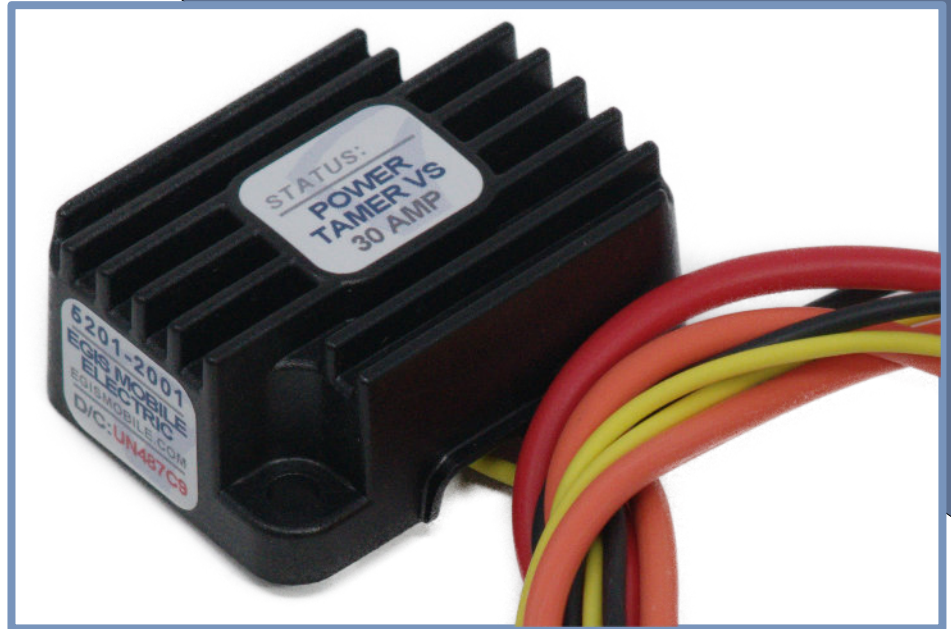

**P/N: 5201**

**(Drop-In Replacement to pre-2019 Power Tamer VS)**

Recommended for Legacy Installations. For New Installs We Recommend PN 5601 With Additional Features & Higher Amperage



**P/N: 5201-2001**



**Ultra-Low Power Draw** eliminates vehicle downtime due to dead batteries. Lowest off-state current draw (1.3 mA).



**Flexible Control Options** via Ignition Key, alternator voltage sense, or both.



**Diagnostic Feedback** via on-board multi-color LEDs



**Meets Stringent OEM Standards** for electrical transient self-protection



**Adjustable OFF Time Delay:** 15 minutes to 4 hours. 5 second test mode setting for quickly verifying installation.



**Bullet-proof Construction:** Sealed unit, high temperature materials allow mounting anywhere on vehicle. Integrated thermal overload protection



**4 Year Industry Leading Warranty**

# System Diagram / Dip Switches

8 h	4 h	2 h	60 m	30 m	15 m	ON OFF
6	5	4	3	2	1	
TIME DELAY (Additive)						

- 1) Use of Ignition Key On signal strongly recommended for all first responder installations to ensure rapid relay ON and maximize vehicle up-time in adverse situations.
- 2) Delay between Off Trigger and Relay OFF set with Dip Switches 1-6. Time Delay per table above
- 3) If DS1 through DS6= Off, Time Delay = 5 seconds for testing and operational verification
- 4) Time Delay determined by each Dip Switch incrementally. Example: If DS1 & DS4 = ON, Time Delay would be 2 hr 15 min.

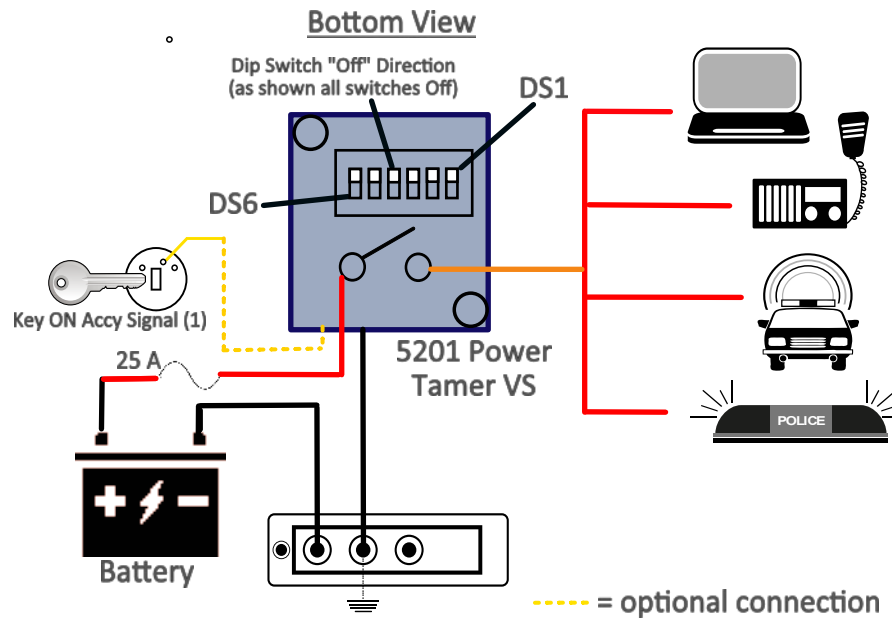

## Dimensions

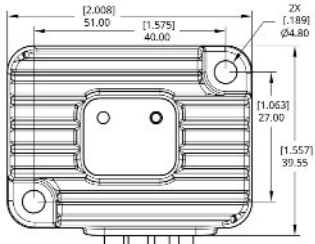

P/N: 5201-2001

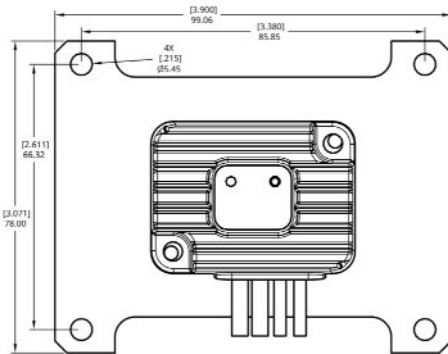

P/N: 5201

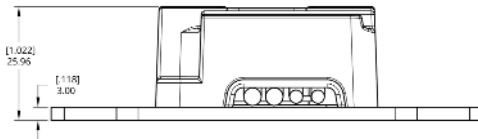
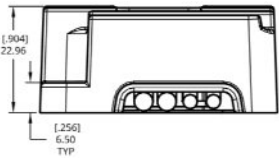

## Specifications

Nominal Voltage	12 Vdc
Voltage Range	8 - 18 Vdc
Max Current (2 min / Continuous)	30 A / 20 A
Device Current Draw, ON State	15 mA
Device Current Draw, OFF State	1.3 mA
ON Voltage Threshold	13.25 Vdc
OFF Voltage Threshold	12.7 Vdc
Housing Material	Polycarbonate
Input Wire Size (Red)	12 AWG / 18 in.
Output Wire Size (Orange)	12 AWG / 24 in.
Ignition Wire Size (Yellow)	18 AWG / 24 in.
Ground Wire Size (Black)	18 AWG / 24 in.
Environmental Withstand	SAE J1455
Over-voltage Protection	17.0 Vdc / 15 sec
Under-voltage Protection	10.5 Vdc / 15 sec

## Methods of Operation

- Relay closes immediately if:
- 1) Key Ignition Input > 8 Vdc or
  - 2) Input Stud Voltage > 13.25 Vdc
- Relay opens after Time Delay setting if:
- 1) Key Ignition Input < 8 Vdc and Input Stud Voltage < 12.7 Vdc
- UV / OV Lock (Under-voltage / Over-voltage Protection):
- 1) Will turn OFF Relay if Input Stud Voltage < 10.5 Vdc or > 17.0 Vdc for 15 Sec
  - 2) Will turn OFF relay regardless of Key ON Accy Signal

**DISCONNECT BATTERY FROM POWER DISTRIBUTION SYSTEM BEFORE INSTALLING PRODUCT TO PREVENT RISK OF ELECTRICAL SHOCK AND PRODUCT DAMAGE**

Recommended for Legacy Installations Only. For New Installs We Recommend PN 5601 (See Our Website / Separate Sales Sheet) With Additional Features & Higher Amperage

Part Numbers	Legacy Drop-In	Compact
PT-VS Bulk Pack	5201	5201-2001
PT-VS Re-Sale Pack	5201R	5201-2001R



3135 Mercer Ave, Suite 102  
 Bellingham, WA 98225  
 360.768.1211  
 sales@egismobile.com

